

**FICHE D'OMOLOGATION  
HOMOLOGATION FORM**



**Motori Seven**

Via Perticara 130  
47023 Cesena (FC)  
ITALY

Costruttore	Manufacturer	<b>Motori Seven</b>
Marca	Make	<b>Motori Seven</b>
Modello	Model	<b>L6 A 70 cc</b>
Tipo di ammissione	Inlet type	<b>Reed Valve</b>
Numero di pagine	Number of pages	<b>16</b>



FOTO DEL MOTORE  
DRAWING OF ENGINE

Firma e Timbro  
Signature and stamp

**MOTORI SEVEN**  
di BENEDETTI OSCAR  
Via Perticara, 130  
47023 CESENA - FC  
Part. IVA 03110790403

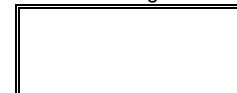

INFORMAZIONI TECNICHE		TECHNICAL INFORMATION	
A	CARATTERISTICHE	A	CHARACTERISTICS
			Tolérances
	Volume del cilindro	<i>Volume of cylinder</i>	<b>69,73</b>
	Alesaggio d'origine	<i>Original Bore</i>	<b>44,95</b>
	Alesaggio teorico massimo	<i>Theoretical maximum bore</i>	<b>45,05</b>
	Corsa	<i>Stroke</i>	<b>43,95</b>
	Sistema di raffreddamento	<i>Cooling system</i>	<b>WATER COOLED</b>
	Numero carburatori	<i>Number of carburation systems</i>	<b>1</b>
	Numero dei canali di travaso	<i>Number of transfer ducts, cylinder/sump</i>	<b>5</b>
	Numero luci di scarico	<i>Number of exhaust ports / ducts</i>	<b>3</b>
	Forma della camera di combustione	<i>Shape of the combustion chamber</i>	<b>SPHERICAL-WITH SQUISH</b>
	Materiali della parete del cilindro	<i>Cylinder wall material</i>	<b>ALL.NIKASIL</b>
	Interasse biella	<i>Length between the axes of the connecting rod</i>	<b>98</b> ±0.1mm
	Numero segmenti pistone	<i>Number of piston rings</i>	<b>1 o 2</b>

B	ANGOLO DI APERTURA SCARICO	B	OPENING ANGLES
	Dello scarico	<i>Exhaust</i>	<b>199°</b> Max

C	MATERIALI	C	MATERIAL
	Cilindro	<i>Cylinder</i>	<b>AL-SI</b>
	Testa	<i>Cylinder head</i>	<b>AL-SI-CU</b>
	Carter	<i>Sump</i>	<b>AL-SI</b>
	Biella	<i>Connecting rod</i>	<b>STEEL NICRMO</b>



DISEGNO DELLO SVILUPPO DEL CILINDRO

DRAWING OF THE CYLINDER DEVELOPMENT

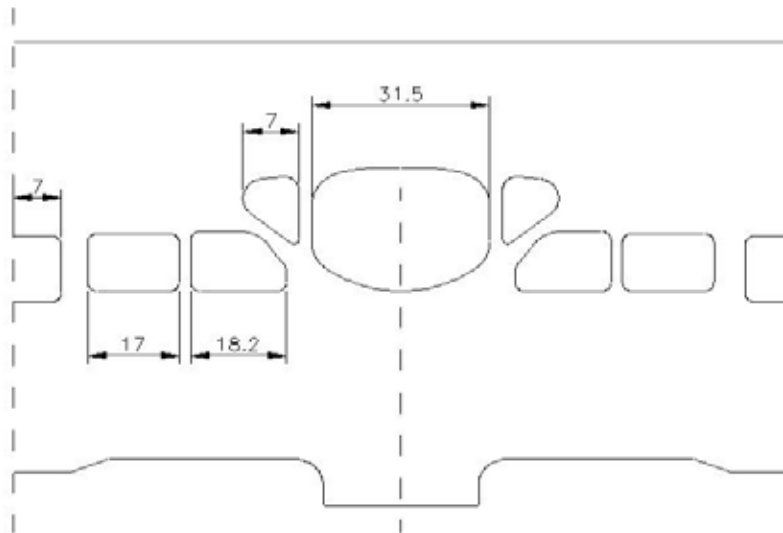
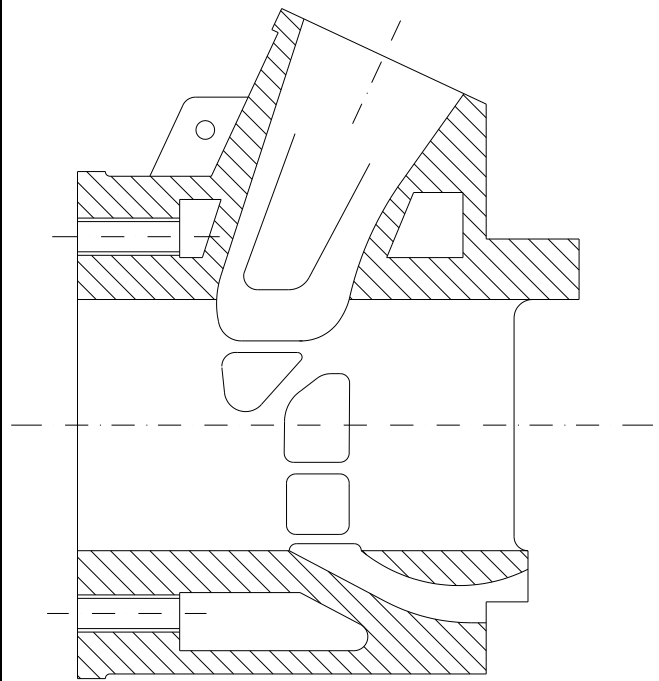
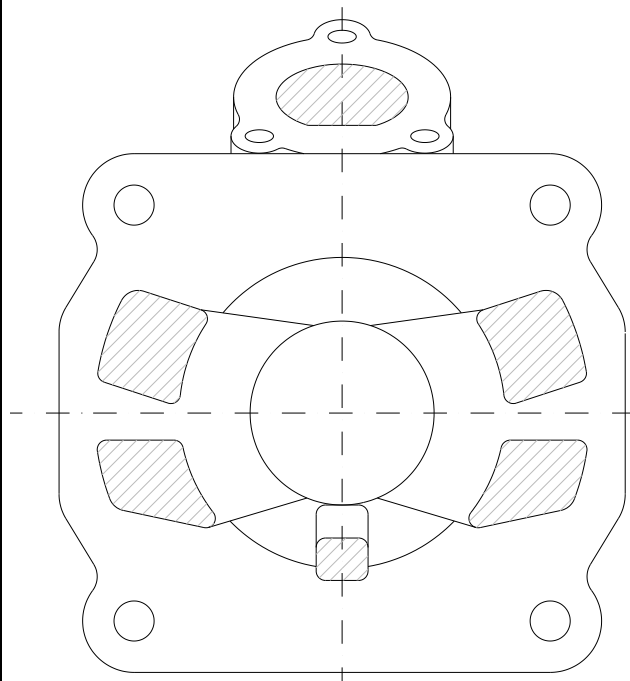
DISEGNO DELLA  
BASE DEL CILINDRODRAWING OF THE  
CYLINDER BASEVISTA SEZIONE DEL  
CILINDROSECTION VIEW OF  
CYLINDER



DISEGNO DELLA CAMERA DI COMBUSTIONE

DRAWING OF THE CYLINDER HEAD AND OF THE COMBUSTION CHAMBER

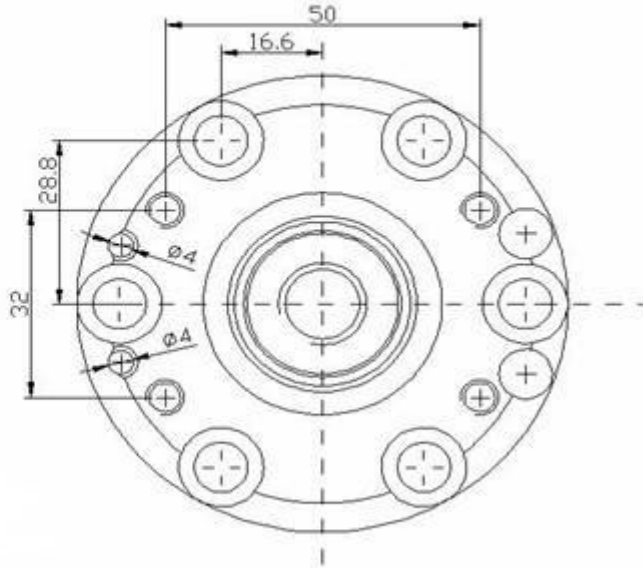
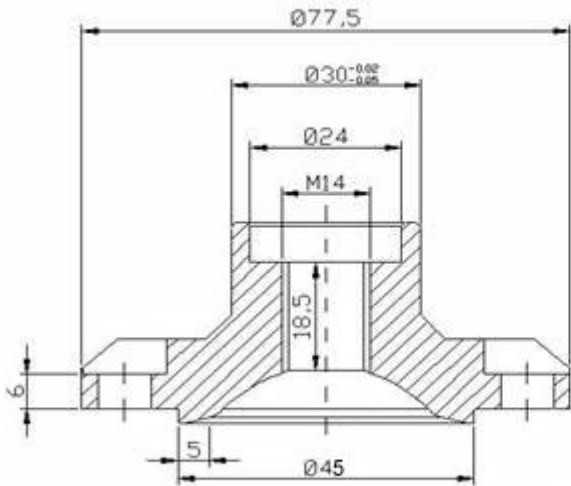

DISEGNO ALBERO MOTORE

PESO = 1478 gr.

DISEGNO INTERNO CARTER

DRAWING OF THE INSIDE OF SUMP











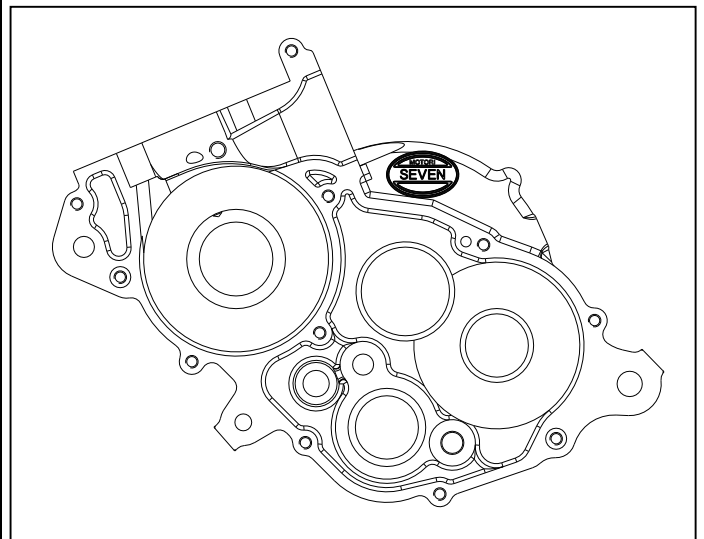
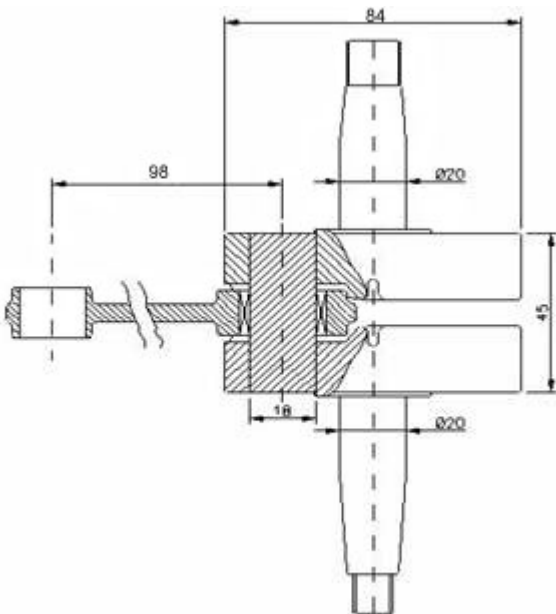

FOTO DEL DIETRO DEL MOTORE	<i>PHOTO OF THE BACK OF THE ENGINE</i>	FOTO DEL DAVANTI DEL MOTORE	<i>PHOTO OF THE FRONT OF ENGINE</i>
			
FOTO DEL MOTORE PARTE SUPERIORE	<i>PHOTO OF THE ENGINE TAKEN FROM ABOVE</i>	FOTO DEL MOTORE PARTE INFERIORE	<i>PHOTO OF THE ENGINE TAKEN FROM BELOW</i>
			

--

FOTO DEL PIEDE DEL CILINDRO	PHOTO OF THE BASE OF THE CYLINDER	FOTO DELLA CAMERA DI COMBUSTIONE	PHOTO OF COMBUSTION CHAMBER
			
FOTO CARTER (VISTA TRE QUARTI )	PHOTO OF THE SUMP ( GASKET FACE )	FOTO DI UNA PARTE INTERNA DEL CARTER	PHOTO OF AN INTERNAL PART OF THE SUMP
			



DISEGNI PACCO LAMELLARE

DRAWING OF REED VALVE

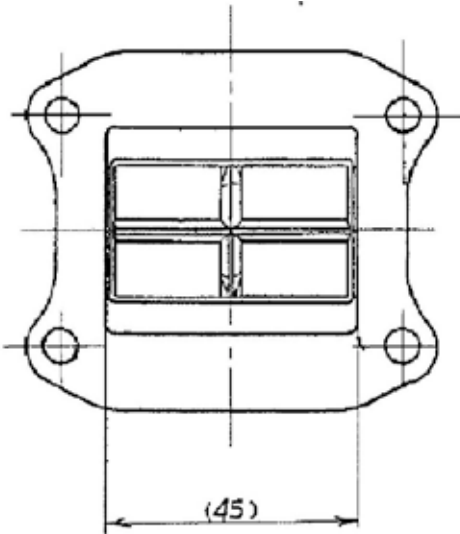
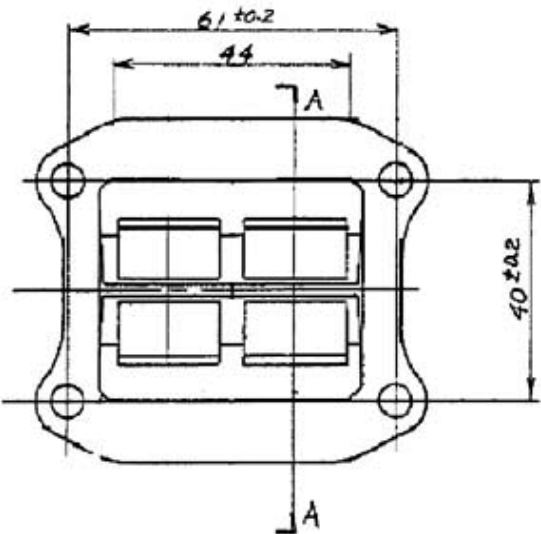
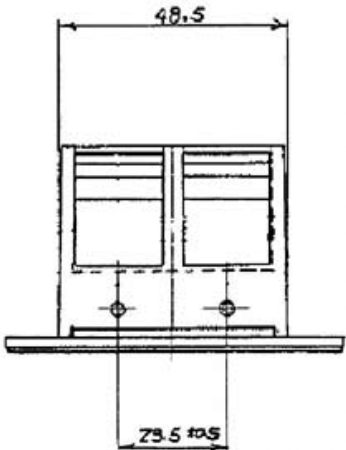
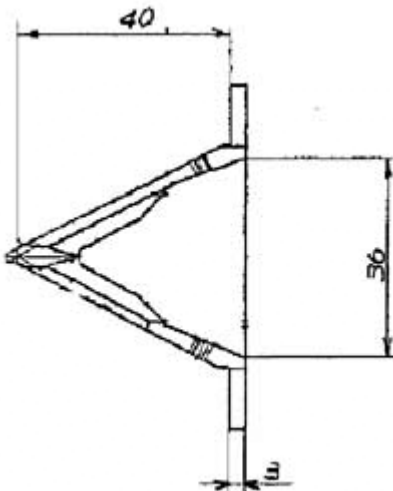

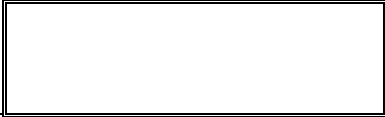

**IGNITION**

Manufacturer PVL ad anticipo fisso

bobina analogica omologata cik fia

**PHOTO OF IGNITION**

**PHOTO OF COIL**

*(insert photo here)*



*(Insert photo here)*





--

CAMBIO DI VELOCITA		GEARBOX	
Coppia primaria		<i>Primary coupling</i>	<b>64-18</b>
Rapporti del cambio		<i>Gearbox ratios</i>	
<i>Marcia</i>	<i>Albero primario</i>	<i>Albero secondario</i>	
<i>Gear</i>	<i>Primary shaft</i>	<i>Secondary shaft</i>	
1 <sup>ere</sup> /1 <sup>st</sup>	<b>14</b>	<b>35</b>	
2 <sup>e</sup> /2 <sup>nd</sup>	<b>17</b>	<b>32</b>	
3 <sup>e</sup> /3 <sup>rd</sup>	<b>18</b>	<b>27</b>	
4 <sup>e</sup> /4 <sup>th</sup>	<b>21</b>	<b>27</b>	
5 <sup>e</sup> /5 <sup>th</sup>	<b>21</b>	<b>24</b>	
6 <sup>e</sup> /6 <sup>th</sup>	<b>22</b>	<b>23</b>	

FOTO DELLO SCARICO	PHOTOS OF THE EXHAUST
	

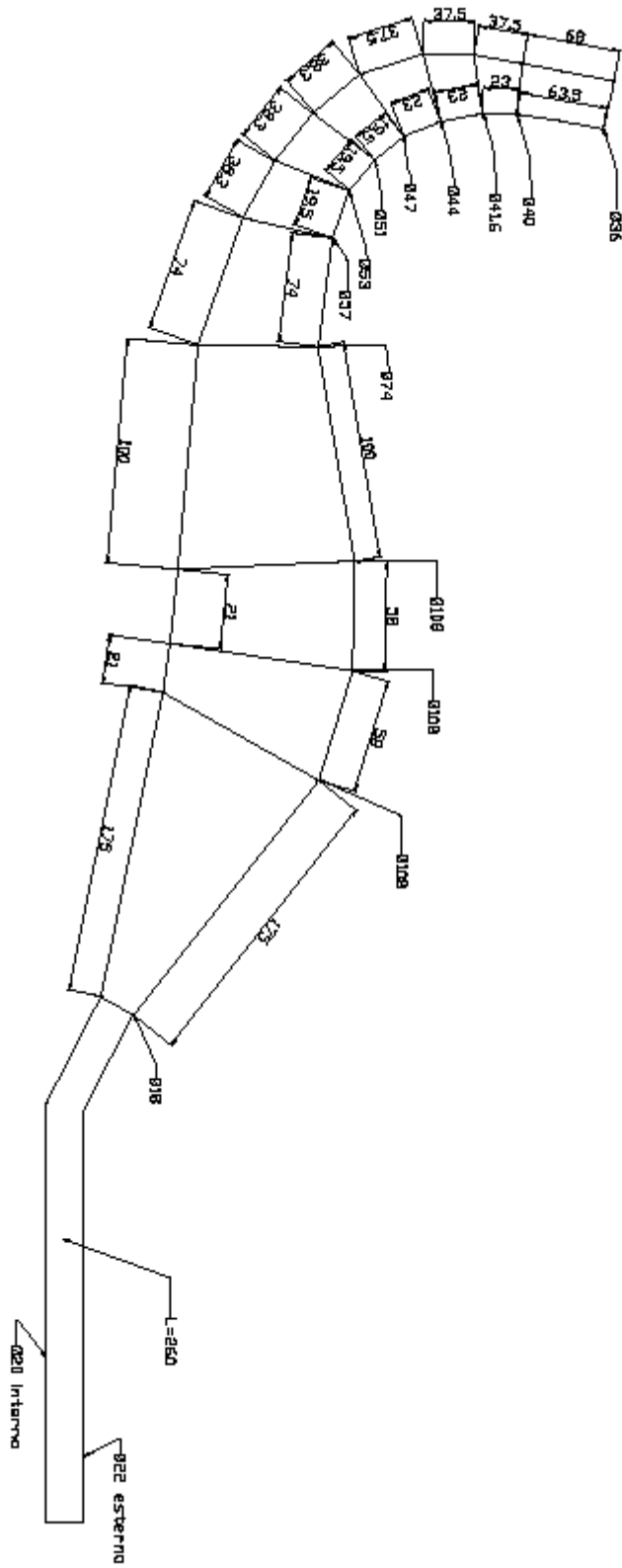

# MOTORI SEVEN



**SUSPENSION**

Manufacturer EXTREME TECH

Manufacturer MARZOCCHI

**PHOTO OF BACK SUSPENSION**

**PHOTO OF FRONT SUSPENSION**



**WHEEL**

Manufacturer SEVEN

**PHOTO OF BACK WHEEL**

**PHOTO OF FRONT WHEEL**

*(insert photo here)*

*(Insert photo here)*



Homologation N°

--

DISEGNO DEL TELAIO

DRAW OF THE CHASSIS

Homologation N°

FOTO MOTO CON CARENA LATO DESTRO

PHOTO OF THE MOTORBIKE RIGHT SIDE



Homologation N°

FOTO MOTO CON CARENA LATO SINISTRO

PHOTO OF MOTOBIKE LEFT SIDE



Homologation N°

FOTO MOTO LATO SINISTRO

PHOTO OF MOTOBIKE LEFT SIDE



Homologation N°

--

FOTO MOTO LATO DESTRO

PHOTO OF MOTOBIKE RIGHT SIDE

